

RIOM 19 000 INHAB.  
MEDICAL SHORTAGE



SCI CARPEDIEM IMMORIOM

## Offers

### Your medical office close to your patients

In RIOM town Center, a beautiful medical office with PRM(people of reduced mobility) access comprising **three medical cabinets:** well-lit with areas of 16 to 27m<sup>2</sup>, a spacious waiting room (including WC with PRM access) and a fully-equipped kitchen.

Visit our site:

[https://goo.gl/xZVgJ1.](https://goo.gl/xZVgJ1)

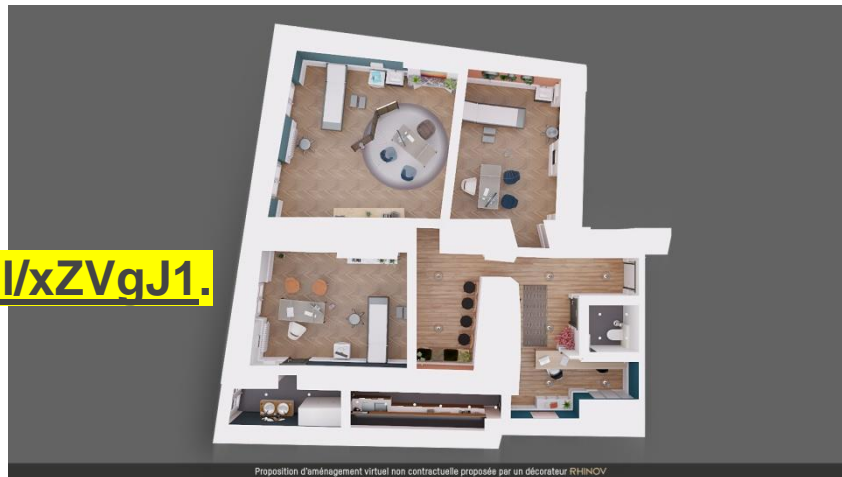

In a newly renovated facility, this professional office features :

**Individual gas central heating**

**Double glazing**

**Door with 3 point security lock and colour videophone**

**Lift for persons with reduced mobility**

**Parking in a private garage**

**Numerous parking options for patients**

*Real estate operation without agency or agency fees*

To Rent or Sell - (rental fees of 322€ to 454€ /month without condominium fees).

**Contact us**

[sci.carpediem@orange.fr](mailto:sci.carpediem@orange.fr)

**06.81.91.31.00**



## Between Nature and City

**RIOM** is a French town

in the Puy de Dôme department of the  
Auvergne Rhône Alpes Region.



**Located at the entrance to a Volcanic National Park, recently classed as a UNESCO world heritage site and close to Clermont-Ferrand, Riom is a moderate sized town with a high standard of living.**



**RIOM is a city rich in Arts and History**

**The town evolves through a variety of cultural seasons,  
It hosts a weekly market and top notch infrastructure.**

**(Cinema, swimming pool, sports facilities, museums and media library).**

**RIOM is close to:**

- **The international airport of Clermont-Ferrand  
15 min**
- **At the intersection of two major European  
Road networks (Paris to the Mediterranean  
Sea, Geneva to Bordeaux)**
- **30 min to ski resorts, mountains and lakes**



The Market, which is one of the biggest in the region  
offers a wide choice of fresh  
local products.







## SOME FACTS

## INHABITANTS

**RIOM town/ 19 000 inhabitants**

(Riom Communauté : 32 000 inhabitants)

## ALTITUDE

Riom Communauté : 330 to 500 m

## AREA

Riom Communauté : 9 200 hectares

## SCOLAR ACTIVITIES

Kindergartens	5
Elementary Schools	6
Middle Schools	3
High Schools	4

## SPORTS ACTIVITIES

Gymnasiums	5
Sports stadiums	4
Swimming Pool	1

## CULTURAL ACTIVITIES

Plastic Arts School	1
Music School	1
Library	1
Museums	3
Cinema	1
Media library	1

## SHOPS

Clothing	30	Shoe stores	6
Bakeries	10	Chocolate shops	3
Delicatessen	9	Butchers	6
Wine shops	3	Fine grocery	3
Cheese shops	1	Fish Shop	1
BIO Shops	3		

## ADMINISTRATION

Courts of Appeals





## MEDICAL ENVIRONMENT

RIOM is a city which hosts both general and specialist doctors.

**There are only 10 General Doctors** (including just one Acupuncturist and no Homeopathic carers) in the town.

**Homeopathic doctors** have not been replaced since their retirement in 2013 and 2018. This situation leaves many patients without a medical alternative.

**The number of doctors is not enough to meet community needs.**

### Specialists:

- 5 paediatricians
- 2 gynaecologists
- 4 ophthalmologists
- 1 rheumatologist
- 3 dermatologists
- 3 cardiologists
- 1 otorhinolaryngologist
- 6 gastroenterologists
- 4 angiologists
- 2 psychiatrists
- 4 radiologists

### RIOM HOSPITAL

#### CARE SERVICES

Polyvalent Medicine – Day care Hospital – Cardiac specialty – Surgery - Consultations – Geriatric unit

EHPAD – Sanitary Unit

#### TECHNICAL FACILITIES

Operating rooms - Laboratory – Radiology - Pharmacy

#### SPECIFIC SERVICES

**ADDICTOLOGY** – care team for addictology

**LA PASS**-Permanent access to health care

**FAMILIAL EDUCATION**-Centre for family planning and education.